



# MANHATTAN MALL



# NYC's Only Indoor Shopping Mall

Manhattan Mall is located in the heart of Midtown Manhattan, 1/2 block from the Empire State Building, Penn Station and Madison Square Garden. The anchor tenant, JCPenney, is located on the lower level and the main and upper floors are home to dozens of individual retailers to satisfy every shopper's need.



MANHATTAN MALL



# Retail

## Space Available

### SECOND FLOOR

Space A: 10,431 SF

Space B: 2,770 SF

Space C: 1,017 SF

Space D: 1,005 SF

Space E: 4,698 SF

Space F: 984 SF

### GROUND FLOOR

33<sup>RD</sup> STREET

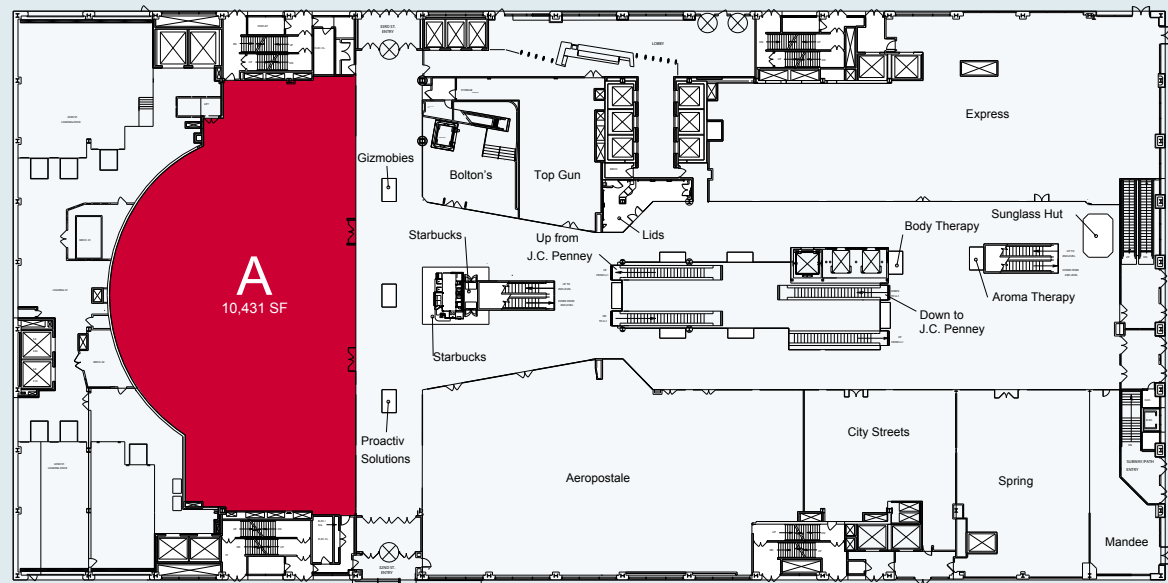

BROADWAY & SIXTH AVENUE

32<sup>ND</sup> STREET

### SECOND FLOOR

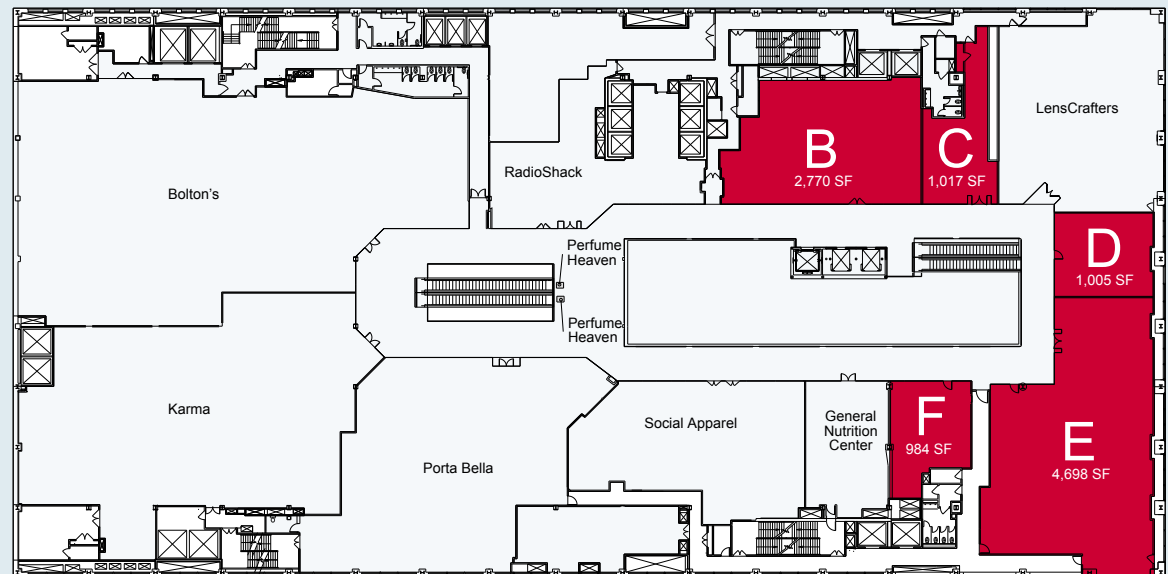

MANHATTAN MALL

# RETAIL

## Neighborhood Map

For leasing information please contact:

**Edward P. Hogan**  
 ehogan@vno.com  
 212.894.7988

**Lucy Phillips**  
 lphillips@vno.com  
 212.894.7992

**VORNADO**  
 REALTY TRUST

