



19,690 RSF OFFICE LOFT
IN GREENWICH VILLAGE

770 BROADWAY

WHITE BOXED LOFT SPACE WITH TERRA COTTA BARREL VAULTED CEILINGS
VIEWS OVERLOOKING GREENWICH VILLAGE TO MEATPACKING AND UP TO UNION SQUARE
4 PRIVATE ELEVATORS
BRAND NEW MOSAIC TILE RESTROOMS WITH SHOWERS
FLEXIBLE TERM (THROUGH OCTOBER 31, 2022 OR LONGER)
LANDLORD WILL TURN-KEY

10TH FLOOR
AVAILABLE

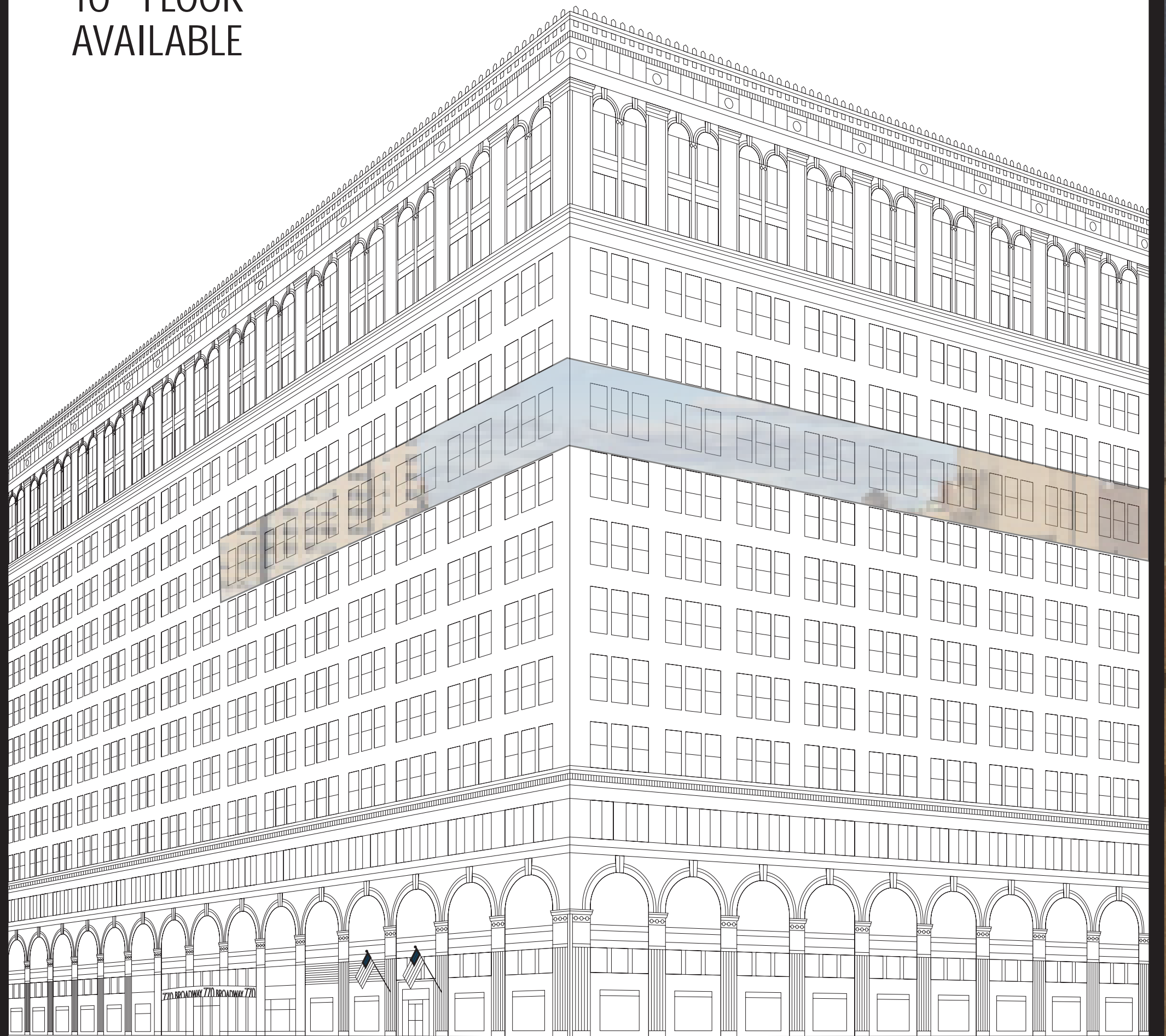

FLOOR
10

10TH FLOOR

TEST FIT PLAN

FINANCIAL TENANT

PRIVATE OFFICES	5
BENCHING DESKS	25
CONFERENCE / MEETING	6
PANTRY	2
FITNESS	1

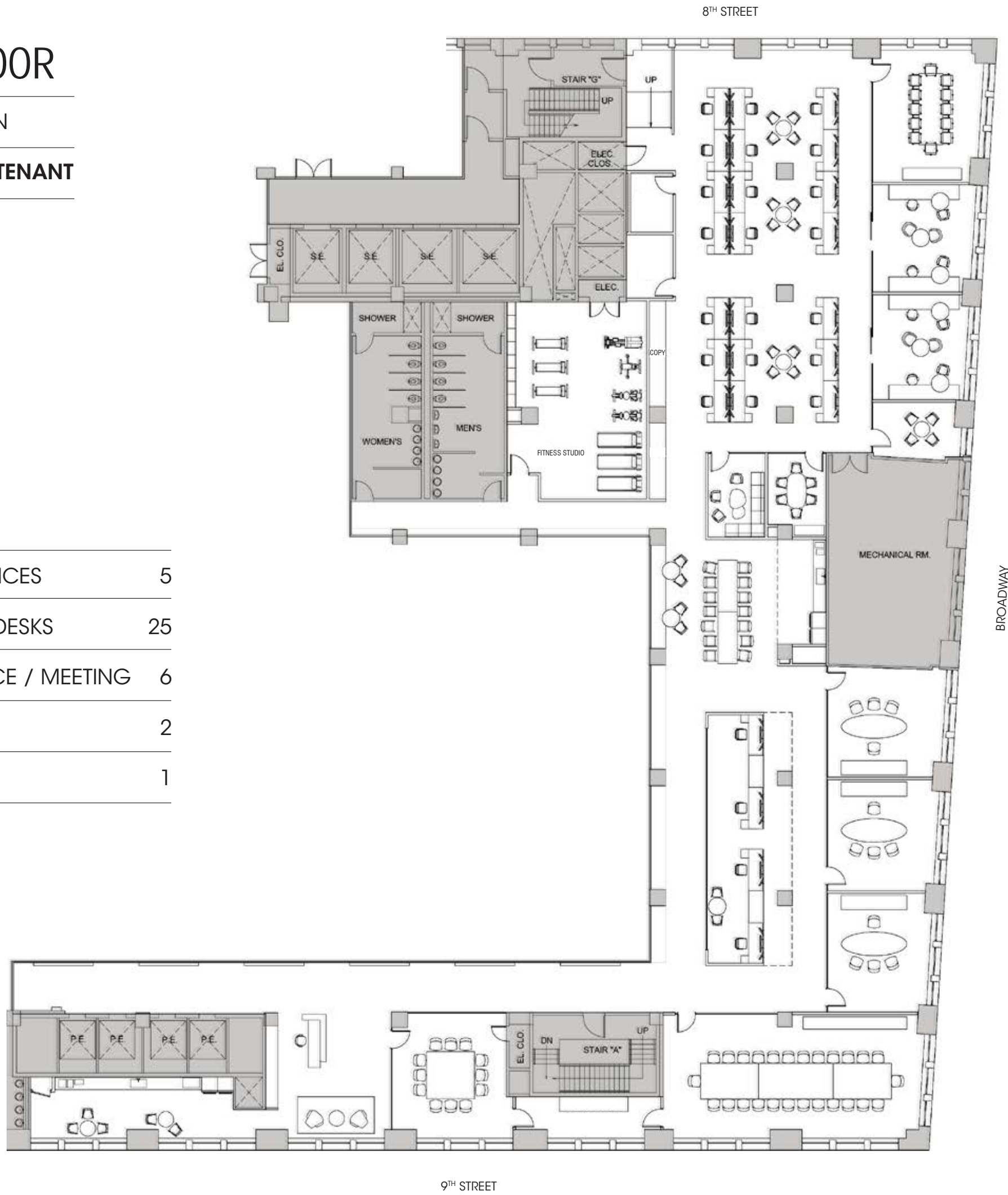

8TH STREET

BROADWAY

9TH STREET

10TH FLOOR

TEST FIT PLAN

CREATIVE TENANT

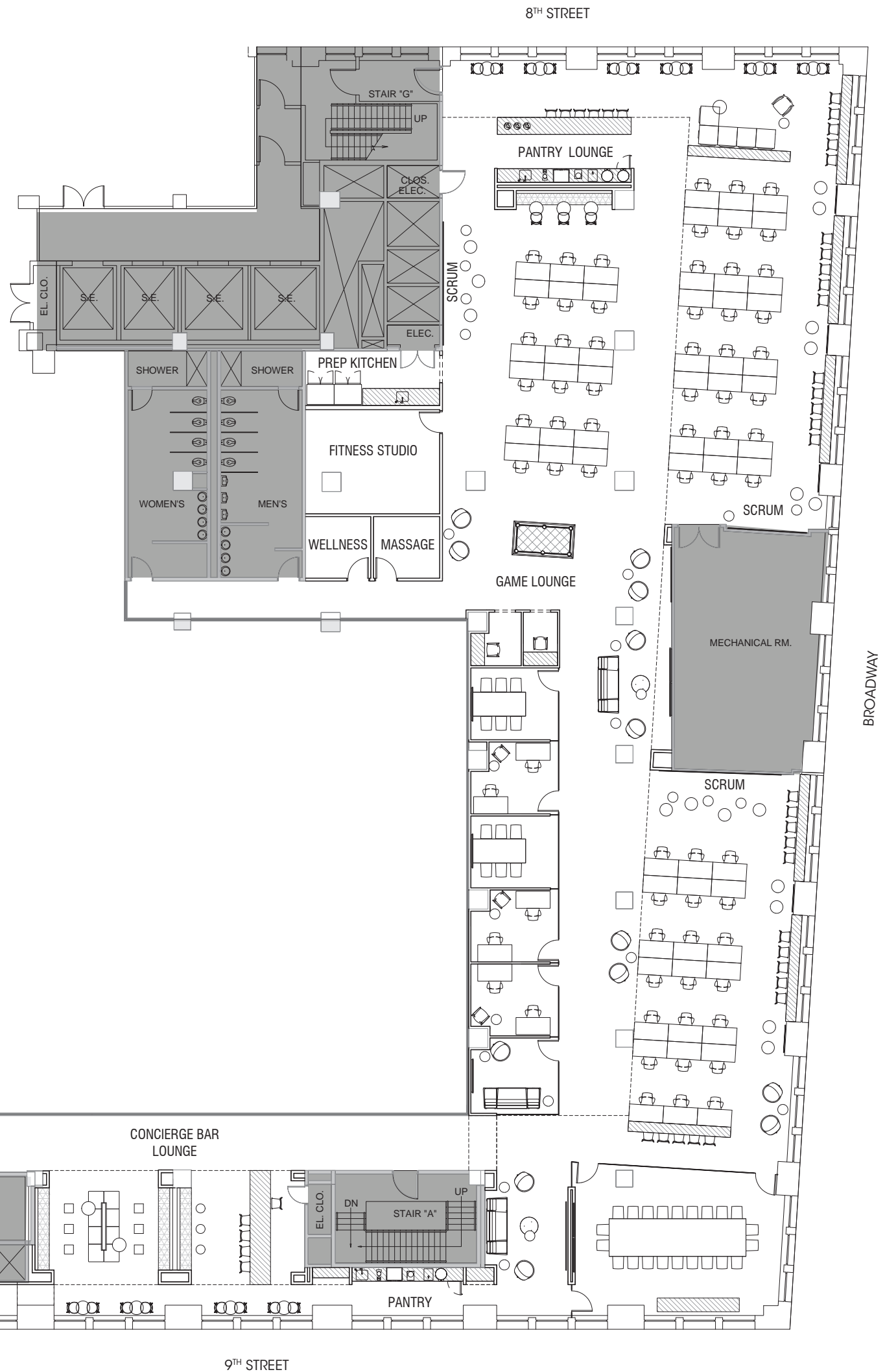

PRIVATE OFFICES	6
BENCHING DESKS	63
CONFERENCE / MEETING	3
PANTRY / LOUNGE	6
FITNESS / OTHER	3

BRAND NEW
MOSAIC TILE RESTROOMS
WITH PRIVATE SHOWERS



4 PRIVATE ELEVATORS
THAT SERVICE ONLY THIS
PORTION OF THE 10TH FLOOR



VIEWS OF UNION SQUARE & THE EMPIRE STATE BUILDING



VIEWS OF GREENWICH VILLIAGE & THE MEATPACKING DISTRICT



VIEWS OF ONE WORLD TRADE CENTER



GREENWICH VILLAGE & ASTOR PLACE





NEIGHBORS @
 770 BROADWAY

FACEBOOK

AOL

J.CREW

770 BROADWAY

VORNADO
REALTY TRUST

JOSH GLICK
212.894.7413
JGLICK@VNO.COM

EDWARD RIGUARDI
212.894.7923
ERIGUARDI@VNO.COM

